

# Linear Way F

## LWFH/LWFF/LWFS

**IKO Linear Way F** is a linear motion rolling guide, featuring a wide track rail along which a highly rigid slide unit performs endless linear motion. A large number of large diameter steel balls are incorporated in two rows and in four point contact with the raceways, so stable high accuracy and rigidity can be obtained in operations even under fluctuating loads with changing direction and magnitude or complex loads. Being a wide rail type, it can support a large moment load acting around the axial direction, and it is also suitable for single row rail arrangement.

### Wide structure

Because the distance between the load points under a moment load is large, this guide has high load capacity under moment load and complex load.

### Flange type and block type

Three types of slide units are available; two flange types of different dimension series and one block type with a narrower width.

### Stainless steel type

The stainless steel type has excellent corrosion resistance and is the most suitable for machines and equipment used in clean environments, for example, medical equipment, and semiconductor and FPD manufacturing equipment.

### Interchangeable

Linear Way F includes interchangeable specification products. The dimensions of slide units and track rails of this specification are individually controlled, so that the slide units and track rails can be combined, added or exchanged freely.

### Good load balance

Owing to the simple two row design, large diameter steel balls are incorporated to receive loads in all directions with high load ratings.

### High rigidity

Steel balls are arranged in four point contact with the raceways in a highly rigid casing, and they are tightly held in their position without play. So high rigidity in all directions is obtained.

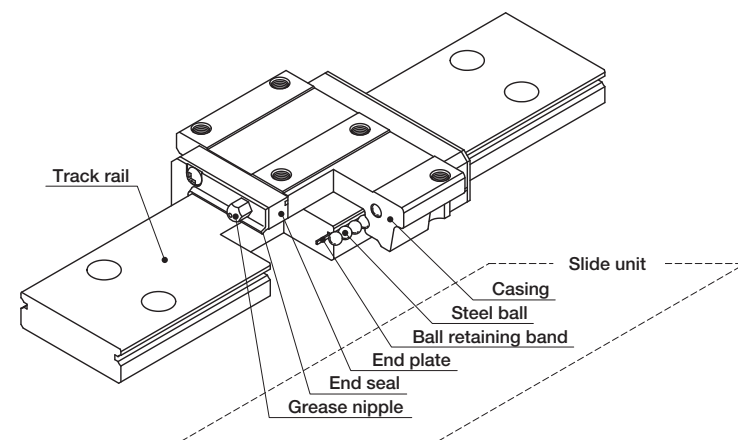

U.S. PATENT No. 6,176,617  
No. 5,967,667  
No. 4,505,522

Structure of Linear Way F

## Linear Way F series

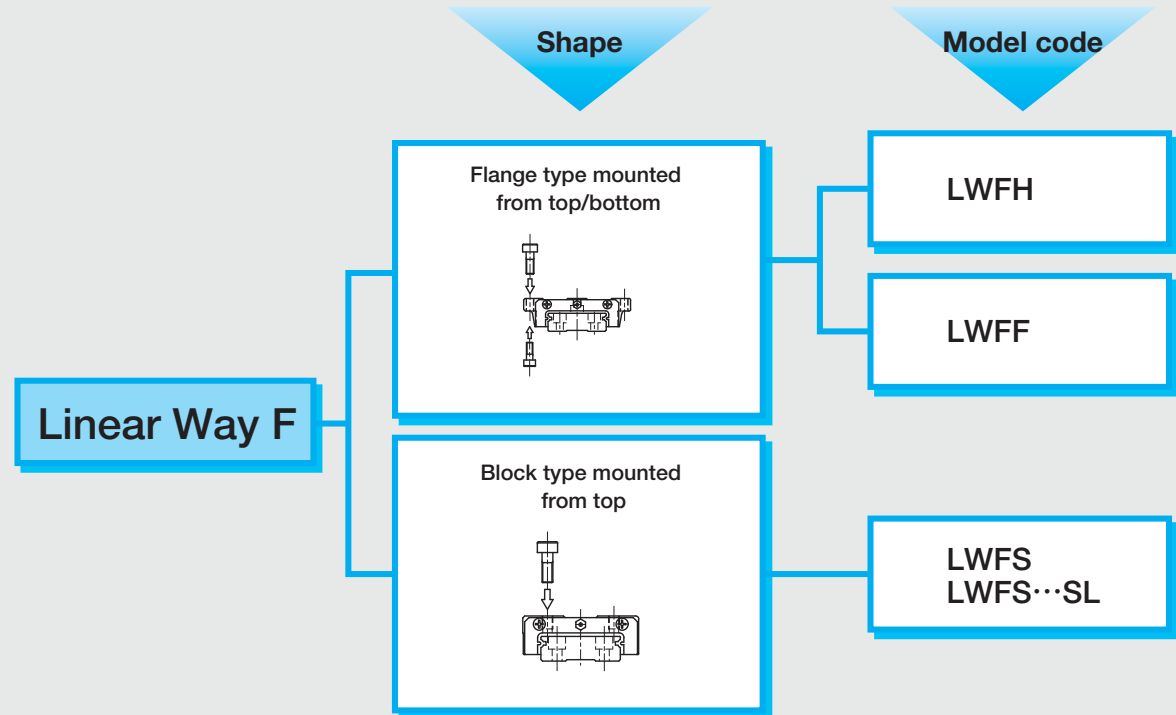

Remark : Models with "SL" are stainless steel type.

## Identification number and specification

The specification of Linear Way F is indicated by the identification number, consisting of a model code, a size, a part code, a material symbol, a preload symbol, a classification symbol, an interchangeable code and any supplemental codes. For details of each specification, see page 78.

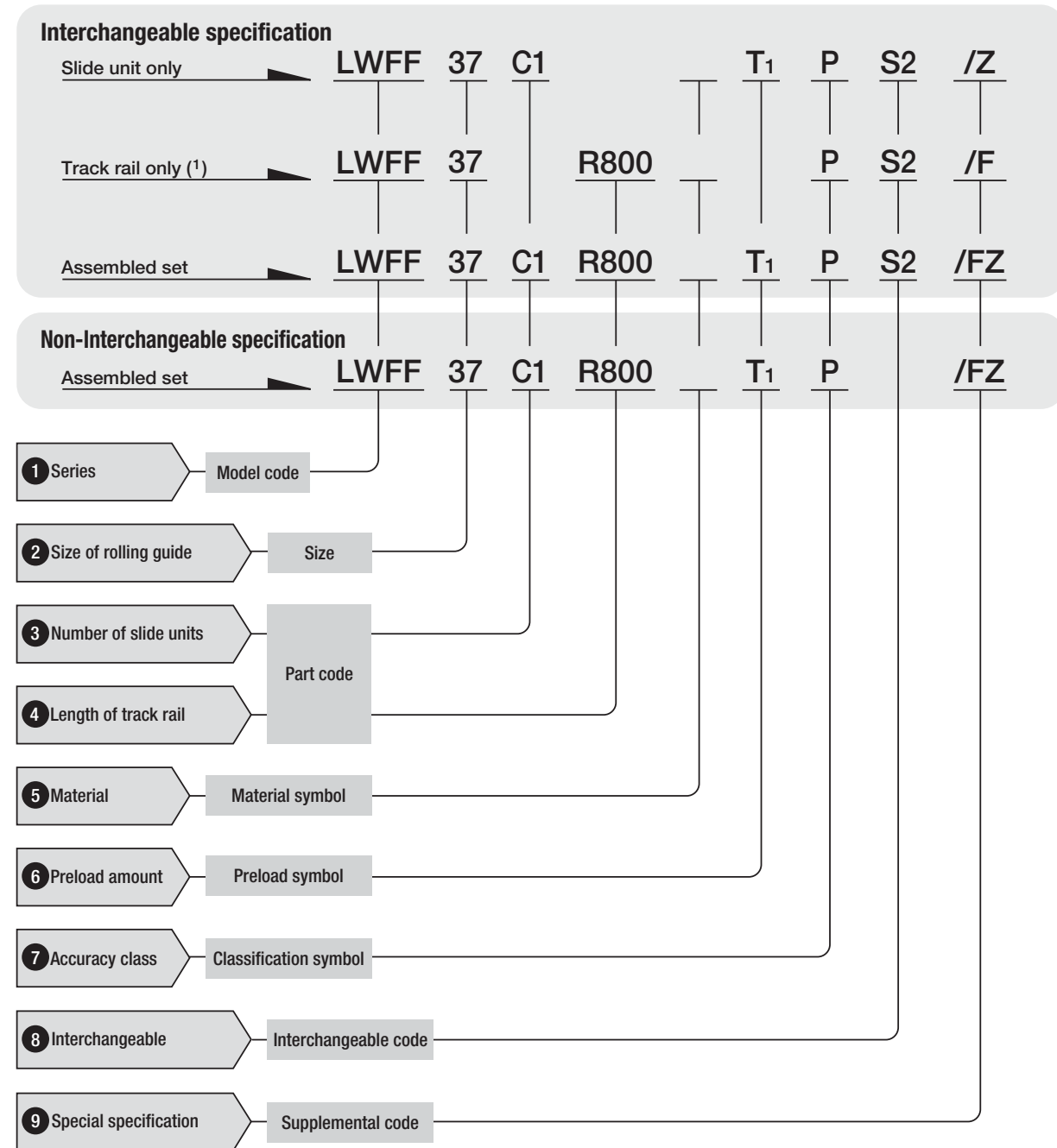

Note(1) : For the model code of a single track rail of interchangeable specification of LWFS, indicate "LWFF".  
Track rail of interchangeable LWFS → Model code LWFF (Ex: LWFF37R800PS2/F)

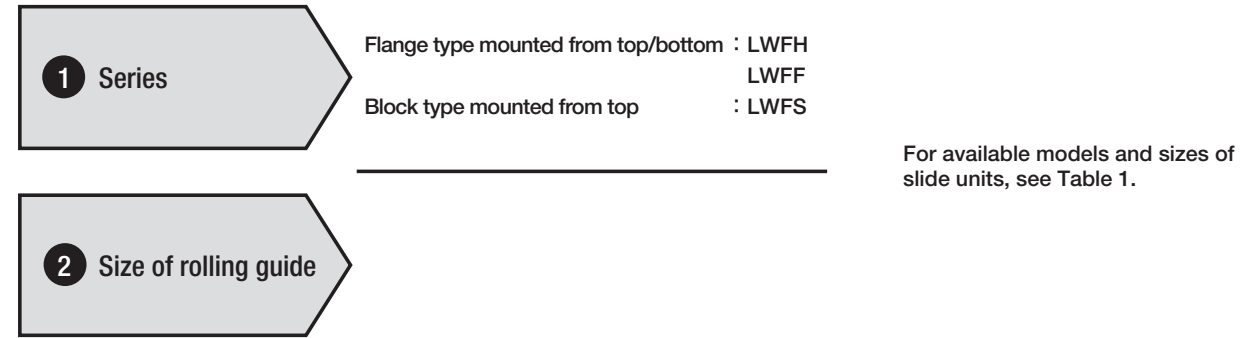
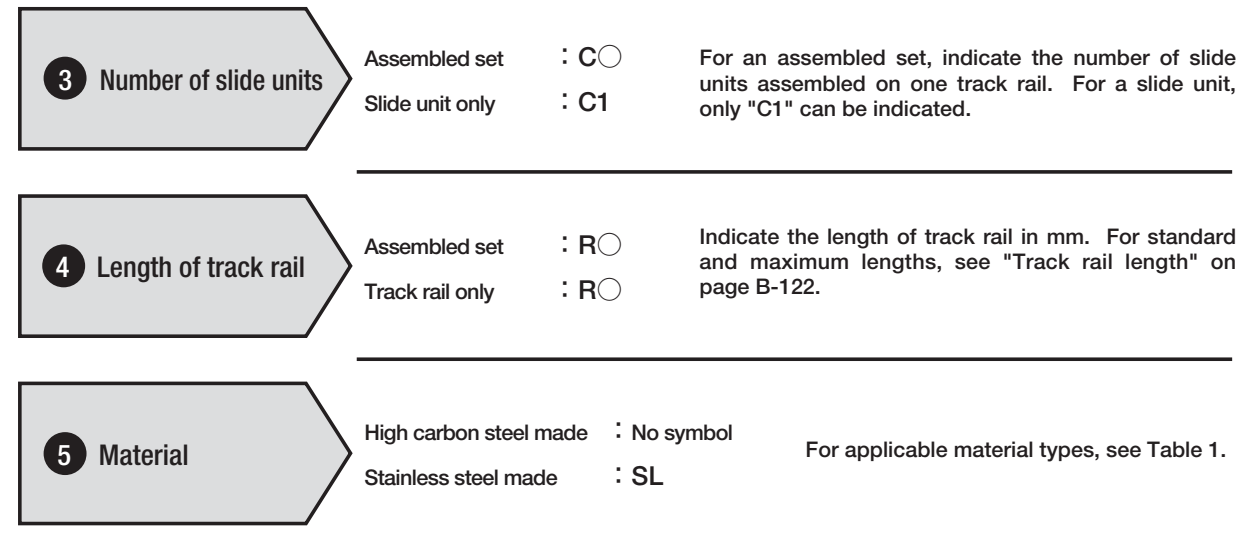

Table 1 Models and sizes of Linear Way F

Model Size	Flange type		Block type	
	High carbon steel made		High carbon steel made	Stainless steel made
	LWFH	LWFF	LWFS	LWFS...SL
33	—	☆	☆	☆
37	—	☆	☆	☆
40	☆	—	—	—
42	—	☆	—	☆
60	☆	—	—	—
69	—	☆	—	—
90	☆	—	—	—

Remark : The mark ☆ indicates that interchangeable specification products are available.



B

LWFH, LWFF, LWFS

**6 Preload amount**

Standard : No symbol  
 Light preload : T1  
 Medium preload : T2

Specify this item for an assembled set or a single slide unit. For applicable amount, see Table 2. For details of preload amount, see page 86.

Table 2 Applicable preload types

Size	Preload type (Symbol)		
	Standard (No symbol)	Light preload (T1)	Medium preload (T2)
33	☆	☆	○
37	☆	☆	○
40	☆	☆	○
42	☆	☆	○
60	☆	☆	○
69	☆	☆	○
90	☆	☆	○

Remark : The mark ☆ indicates that it is also applicable to interchangeable specification products.

**7 Accuracy class**

High : H  
 Precision : P  
 Super precision : SP

For applicable accuracy, see Table 3. For the interchangeable specification, combine slide units and track rails of the same class. For details of accuracy, see page 81.

Table 3 Applicable accuracy class

Size	Accuracy class (Symbol)		
	High (H)	Precision (P)	Super precision (SP)
33	☆	☆	○
37	☆	☆	○
40	☆	☆	○
42	☆	☆	○
60	☆	☆	○
69	☆	☆	○
90	☆	☆	○

Remark : The mark ☆ indicates that it is also applicable to interchangeable specification products.

**8 Interchangeable code**

Select group 1 : S1  
 Select group 2 : S2

Specify this item for interchangeable specification products. Combine track rails and slide units with the same interchangeable code. Performance and accuracy of "S1" group and "S2" group are the same.

**9 Special specification**

For applicable special specifications, see Tables 4.1 and 4.2. When several special specifications are required, see Table 5. For details of special specifications, see page 88.

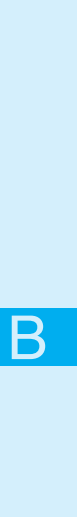

LWFH, LWFF, LWFS

Table 4.1 Special specifications of LWFH

Special specification	Supplemental code	Assembled set	Track rail	Slide unit	Dimension
Butt-jointing track rail	A	○	—	—	
Chamfered reference surface	C	○ (1)	—	—	See Fig. 1.
Opposite reference surfaces arrangement	D	☆	—	—	
Specified rail mounting hole positions	E	☆	☆	—	
Caps for rail mounting holes	F	☆	☆	—	
Inspection sheet	I	○	—	—	
Female threads for bellows	J	☆	☆	☆	See Table 6.1.
Black chrome surface treatment	L	☆	—	—	
Fluorine black chrome surface treatment	LF	☆	—	—	
Supplied without track rail mounting bolt	MN	☆	☆	—	
No end seal	N	☆	—	☆	
Capillary plates	Q	☆	—	☆	See Table 7.
Under seals	U	☆	—	☆	See Table 8.
Matched sets to be used as an assembled group	W	○	—	—	
Specified grease	Y	☆	—	—	
Scrapers	Z	☆	—	☆	See Table 10.

Note(1) : Applicable to size 40 and 60 models.

Remark : In the table, the mark ☆ indicates that it is also applicable to interchangeable specification products.

Table 4.2 Special specifications of LWFF, LWFS

Special specification	Supplemental code	Assembled set	Track rail	Slide unit	Dimension
Butt-jointing track rail	A	○	—	—	
Opposite reference surfaces arrangement	D	☆	—	—	
Specified rail mounting hole positions	E	☆	☆	—	
Caps for rail mounting holes	F	☆	☆	—	
Inspection sheet	I	○	—	—	
Female threads for bellows	J	☆ (1)	☆ (1)	☆	See Table 6.2.
Black chrome surface treatment	L	☆	—	—	
Fluorine black chrome surface treatment	LF	☆	—	—	
Supplied without track rail mounting bolt	MN	☆	☆	—	
No end seal	N	☆	—	☆	
Capillary plates	Q	☆	—	☆	See Table 7.
Under seals	U	☆ (2)	—	☆ (2)	See Table 8.
Double end seals	V	☆	—	☆	See Table 9.
Matched sets to be used as an assembled group	W	○	—	—	
Specified grease	Y	☆	—	—	
Scrapers	Z	☆	—	☆	See Table 10.

Note(1) : Not applicable to stainless steel made interchangeable specification products.

(2) : The H<sub>1</sub> dimension is the same as the dimension of standard products (without under seals).

Remark : In the table, the mark ☆ indicates that it is also applicable to interchangeable specification products.

Table 5 Combination of special specifications

LWFH													LWFF LWFS																		
C	○												D	○																	
D	○	○											E	—	—																
E	—	○	—										F	○	☆	☆															
F	○	○	☆	☆									I	○	○	○	○														
I	○	○	○	○	○								J	○	☆	☆	☆	○													
J	○	○	☆	☆	☆	○							L	○	☆	☆	☆	○	☆												
L	○	○	☆	☆	☆	○	☆						LF	○	☆	☆	☆	○	☆	—											
LF	○	○	☆	☆	☆	○	☆	—					MN	○	☆	☆	☆	○	☆	☆	☆										
MN	○	○	☆	☆	☆	○	☆	☆	☆				N	○	☆	☆	—	○	—	☆	☆	☆									
N	○	○	☆	☆	☆	○	—	☆	☆	☆			Q	○	☆	☆	☆	○	—	☆	☆	☆	☆								
Q	○	○	☆	☆	—	○	—	☆	☆	☆	☆		U	○	☆	☆	☆	○	☆	☆	☆	☆	—	☆							
U	○	○	☆	☆	☆	○	☆	☆	☆	☆	—	☆	V	○	☆	☆	☆	○	★	☆	☆	☆	—	—	☆						
W	○	○	○	—	○	○	○	○	○	○	○	○	W	○	○	—	○	○	○	○	○	○	○	○	○						
Y	○	○	☆	☆	☆	○	☆	☆	☆	☆	—	☆	○	Y	○	☆	☆	☆	○	☆	☆	☆	☆	☆	—	☆	☆	○			
Z	○	○	☆	☆	☆	○	—	☆	☆	☆	—	—	☆	○	○	Z	○	☆	☆	☆	○	★	☆	☆	☆	—	—	☆	★	○	☆
	A	C	D	E	F	I	J	L	LF	MN	N	Q	U	W	Y		A	D	E	F	I	J	L	LF	MN	N	Q	U	V	W	Y

Remark 1 : In the table, the mark ☆ indicates that it is also applicable to interchangeable specification products.

2 : In the table, the mark — indicates that this combination cannot be made.

3 : The combinations marked ★ are applicable to non-interchangeable specification products.

For combinations of interchangeable specification products, consult IKO for further information.

4 : When several special specifications are required, arrange the supplemental codes alphabetically.

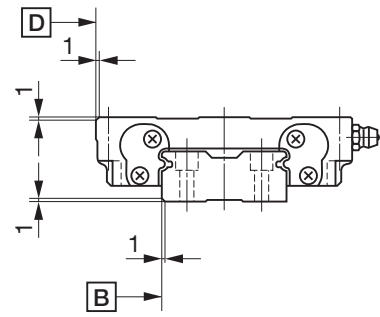
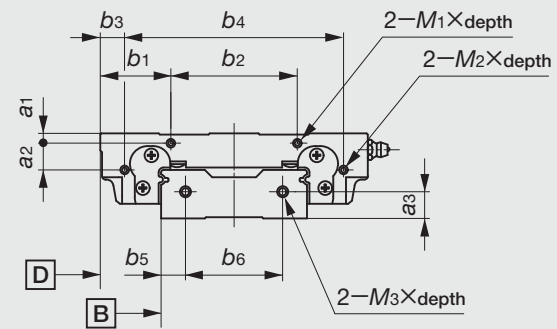

Fig. 1 Chamfers on reference surfaces (Supplemental code /CC)

Table 6.1 Female threads for bellows of LWFH (Supplemental code /J, /JJ)



unit : mm

Model number	Slide unit								Track rail			
	a1	a2	b1	b2	b3	b4	M1xdepth	M2xdepth	a3	b5	b6	M3xdepth
LWFH 40	3	—	23.5	35	—	—	M3x6	—	9	8	24	M3x6
LWFH 60	4	11	29	52	10	90	M3x6	M3x3	11	10	40	M4x8
LWFH 90	6	17	41	80	13	136	M3x5	M3x5	13	15	60	M4x8

Table 6.2 Female threads for bellows of LWFF, LWFS (Supplemental code /J, /JJ)

Size : 33,37,42

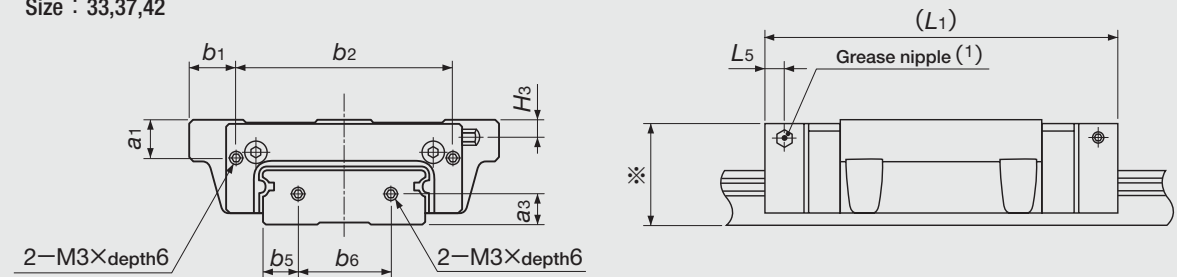

Size : 69

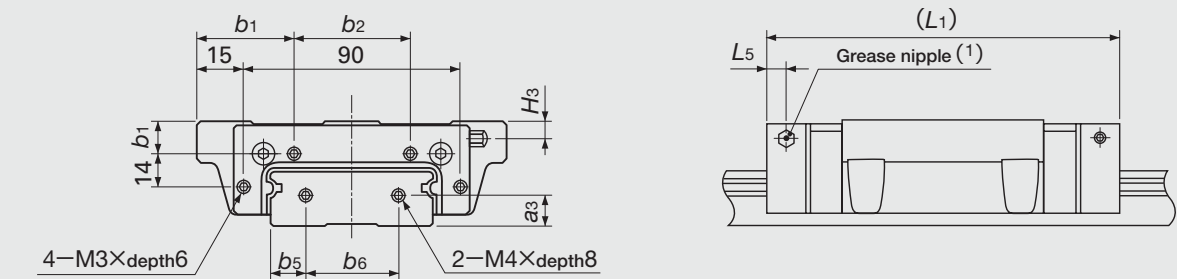

unit : mm

Model number	Slide unit						Track rail		
	a1	b1	b2	L1 <sup>(2)</sup>	L5	H3	a3	b5	b6
LWFF 33	4	8.25	43.5	71	5	1	6	7.5	18
LWFS 33		3.25							
LWFF 37	6	10	48	78	5	1	6.5	8.5	20
LWFS 37		3							
LWFF 42	9.5	12	56	92	7	4.5	8	9	24
LWFS 42...SL		3							
LWFF 69	9	35	50	125	7	5	11	14.5	40

Note<sup>(1)</sup> : The specification and mounting position of grease nipple are different from those of the standard specification product.

For grease nipple specifications, see page 98.

<sup>(2)</sup> : The values for a slide unit with female threads for bellows at both ends are shown.

Remark : For the size 33 and 37 models, the dimension indicated by an asterisk (\*) is higher than the H dimension of Linear Way F.  
For details, consult **I K O** for further information.

Table 7 Slide unit with capillary plates (Supplemental code /Q)

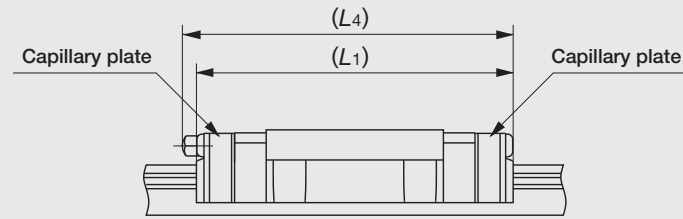

unit : mm

Model number	L <sub>1</sub>	L <sub>4</sub>	Model number	L <sub>1</sub>	L <sub>4</sub>
LWFH 40	78	—	LWFS 33	64	67
LWFH 60	98	—	LWFS 33...SL		
LWFH 90	131	—	LWFS 37	73	75
LWFF 33	64	67	LWFS 37...SL		
LWFF 37	73	75	LWFS 42...SL	86	99
LWFF 42	86	99			
LWFF 69	121	133			

Table 10.1 LWFH slide unit with scrapers (Supplemental code /ZZ)

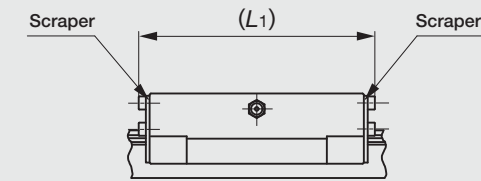

unit : mm

Model number	L <sub>1</sub>
LWFH 40	79.2
LWFH 60	99.2
LWFH 90	130

Remark : The above values are for slide units with scrapers at both ends.

Table 8 H<sub>1</sub> dimension of slide unit with under seals (Supplemental code /U)

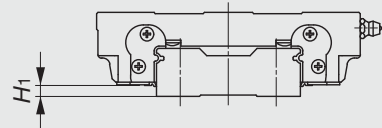

unit : mm

Model number	H <sub>1</sub>
LWFH 40	3
LWFH 60	4
LWFH 90	5

Remark : The H<sub>1</sub> dimension of LWFF and LWFS is the same as that without under seals.

Table 10.2 LWFF and LWFS slide units with scrapers (Supplemental code /ZZ)

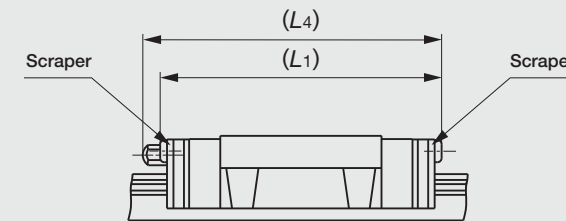

unit : mm

Model number	L <sub>1</sub>	L <sub>4</sub>
LWFF 33	62	64
LWFS 33		
LWFF 37	71	75
LWFS 37		
LWFF 42	84	97
LWFF 69	119	131

Remark : The above values are for slide units with scrapers at both ends.

Table 9 LWFF and LWFS slide units with double end seals (Supplemental code /VV)

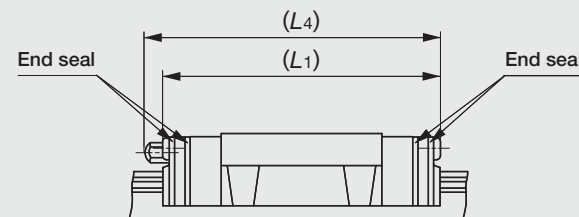

unit : mm

Model number	L <sub>1</sub>	L <sub>4</sub>
LWFF 33	61	64
LWFS 33		
LWFF 37	70	74
LWFS 37		
LWFF 42	82	96
LWFF 69	117	130

Remark : The above dimensions are for slide units with double end seals at both ends.

## Track rail length

Standard and maximum lengths of track rails are shown in Table 11.1 and 11.2. Track rails of any length are also available. Simply indicate the required length of track rail in mm in the identification number. For the tolerances of *E* dimension and track rail length, consult **IKO** for further information.

- For track rails longer than the maximum length shown in Table 11.1 and 11.2, butt-jointing track rails are available upon request. In this case, indicate "/A" in the identification number.
- *E* dimensions at both ends are the same and are within the standard range of *E* unless otherwise specified. To change these dimensions, specify the specified rail mounting hole positions "/E" of special specification. For details, see page 91.

Table 11.1 Standard and maximum lengths of high carbon steel track rails

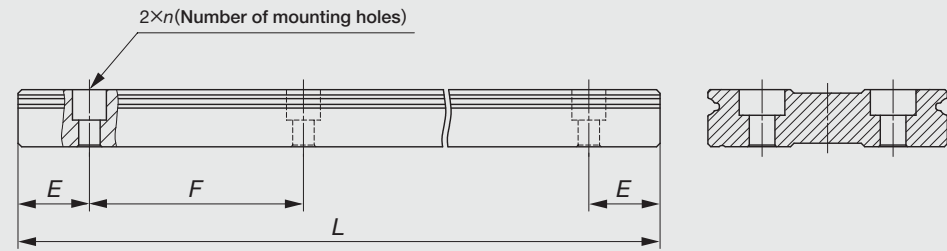

unit : mm

Item	Model number	LWFH 40	LWFH 60	LWFH 90	
Standard length <i>L</i> ( <i>n</i> )		180( 3)	240( 3)	480( 6)	
		240( 4)	480( 5)	640( 8)	
		360( 6)	640( 8)	800(10)	
		480( 8)	800(10)	1 040(13)	
		660(11)	1 040(13)	1 200(15)	
		840(14)		1 520(19)	
Pitch of mounting holes <i>F</i>		60	80	80	
<i>E</i>		30	40	40	
Standard range of <i>E</i> <sup>(1)</sup>	incl.	8	10	10	
	under	38	50	50	
Maximum length <sup>(2)</sup>		1 500	1 520	1 520	
Item	Model number	LWFF 33 LWFS 33	LWFF 37 LWFS 37	LWFF 42	LWFF 69
Standard length <i>L</i> ( <i>n</i> )		120( 3)	150( 3)	180( 3)	320( 4)
		200( 5)	250( 5)	240( 4)	480( 6)
		320( 8)	400( 8)	360( 6)	800(10)
		480(12)	500(10)	480( 8)	1 040(13)
		560(14)	600(12)	660(11)	1 280(16)
			800(16)	840(14)	1 600(20)
Pitch of mounting holes <i>F</i>		40	50	60	80
<i>E</i>		20	25	30	40
Standard range of <i>E</i> <sup>(1)</sup>	incl.	7	7	7	9
	under	27	32	37	49
Maximum length <sup>(2)</sup>		1 600	2 000	1 980	2 000

Note<sup>(1)</sup> : Not applicable to the track rail with female threads for bellows (supplemental code "/J").  
 Note<sup>(2)</sup> : Track rails exceeding the maximum length can also be manufactured. Consult **IKO** for further information.

Table 11.2 Standard and maximum lengths of stainless steel track rails

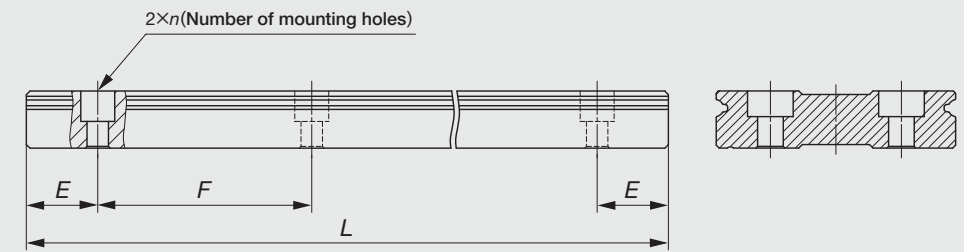

unit : mm

Item	Model number	LWFS 33···SL	LWFS 37···SL	LWFS 42···SL
Standard length <i>L</i> ( <i>n</i> )		120( 3)	150( 3)	180( 3)
		200( 5)	250( 5)	240( 4)
		320( 8)	400( 8)	360( 6)
		480(12)	500(10)	480( 8)
		560(14)	600(12)	660(11)
			800(16)	840(14)
Pitch of mounting holes <i>F</i>		40	50	60
<i>E</i>		20	25	30
Standard range of <i>E</i> <sup>(1)</sup>	incl.	7	7	7
	under	27	32	37
Maximum length <sup>(2)</sup>		1 200	1 200	1 200

Note<sup>(1)</sup> : Not applicable to the track rail with female threads for bellows (supplemental code "/J").  
 Note<sup>(2)</sup> : Track rails exceeding the maximum length can also be manufactured. Consult **IKO** for further information.

Flange type mounted from top/bottom  
LWFH

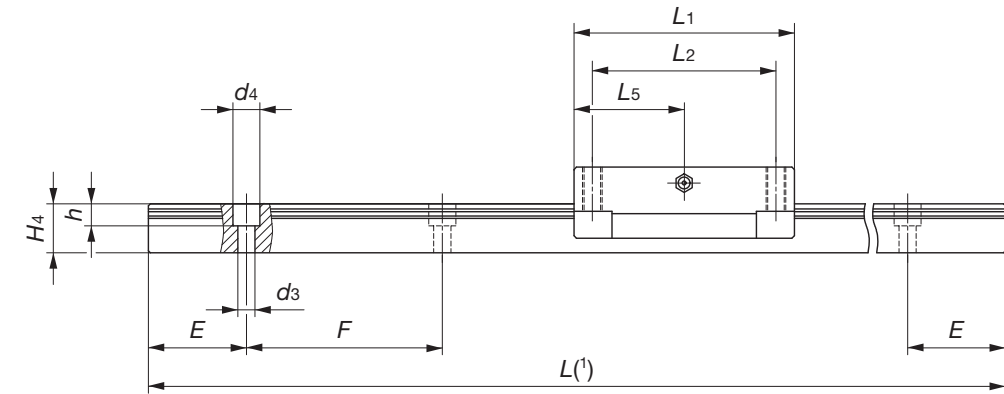
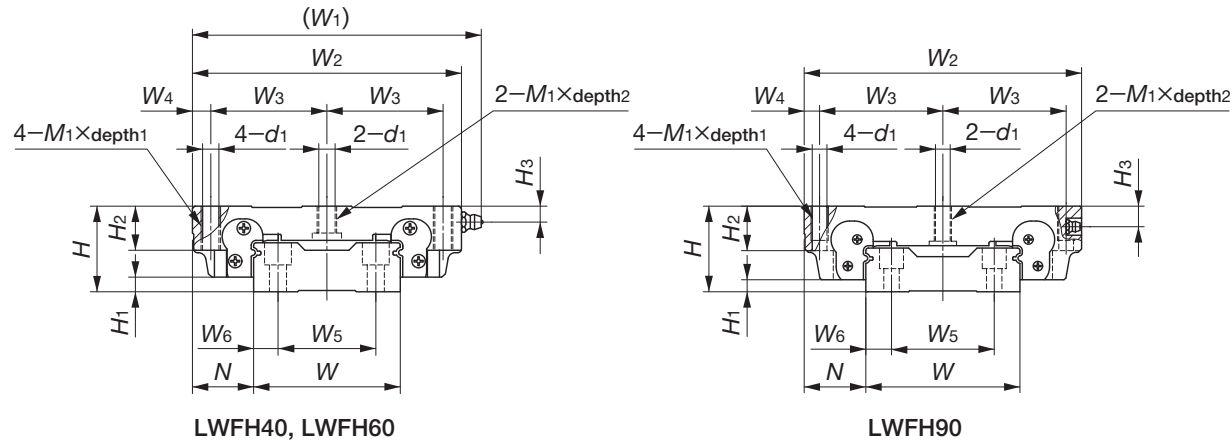

Model number	Interchangeable	Mass (Ref.)		Dimensions of assembly mm			Dimensions of slide unit mm										
		Slide unit kg	Track rail kg/m	H	H <sub>1</sub>	N	W <sub>1</sub>	W <sub>2</sub>	W <sub>3</sub>	W <sub>4</sub>	L <sub>1</sub>	L <sub>2</sub>	L <sub>5</sub>	d <sub>1</sub>	M <sub>1</sub> ×depth <sub>1</sub>	depth <sub>2</sub>	H <sub>2</sub>
LWFH 40	☆	0.58	4.60	27	5	21	92	82	37	4	70	60	27.5	4.3	M 5×14	8	14
LWFH 60	☆	1.29	8.60	35	6	25	120	110	47.5	7.5	90	75	45	6.7	M 8×18	11	18
LWFH 90	☆	4.06	16.5	50	7	36	—	162	72	9	120	100	60	8.6	M10×20	20.5	26

H <sub>3</sub>	Dimensions of track rail mm										Mounting bolt for track rail mm Bolt size x length	Basic dynamic load rating <sup>(2)</sup> C N	Basic static load rating <sup>(2)</sup> C <sub>0</sub> N	Static moment rating <sup>(2)</sup>		
	W	H <sub>4</sub>	W <sub>5</sub>	W <sub>6</sub>	d <sub>3</sub>	d <sub>4</sub>	h	E	F	T <sub>0</sub> N·m				T <sub>x</sub> N·m	T <sub>y</sub> N·m	
6.5	40	16	24	8	4.5	7.2	6	30	60	M4×16	12 600	16 600	280	108 612	99.3 563	
6.5	60	20	40	10	7	11	9	40	80	M6×22	16 100	23 500	600	210 1 090	193 998	
12	90	25.5	60	15	9	14	12	40	80	M8×28	31 600	43 300	1 650	513 2 680	470 2 460	

Note<sup>(1)</sup> : Track rail lengths are shown in Table 11.1 on page B-122.  
<sup>(2)</sup> : The directions of basic dynamic load rating (C), basic static load rating (C<sub>0</sub>) and static moment rating (T<sub>0</sub>, T<sub>x</sub>, T<sub>y</sub>) are shown in the sketches below. The upper values in the T<sub>x</sub> and T<sub>y</sub> columns apply to one slide unit, and the lower values apply to two slide units in close contact.  
 Remark 1 : The mark ☆ indicates that interchangeable specification products are available.  
 2 : The appended track rail mounting bolts are hexagon socket head bolts of JIS B 1176 or equivalent.  
 3 : For grease nipple specifications, see page 99.

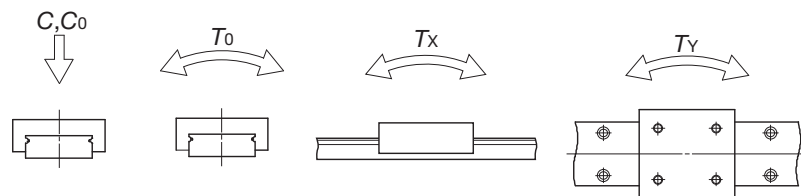

Example of identification number of assembled set (For details, see "Identification number and specification".)

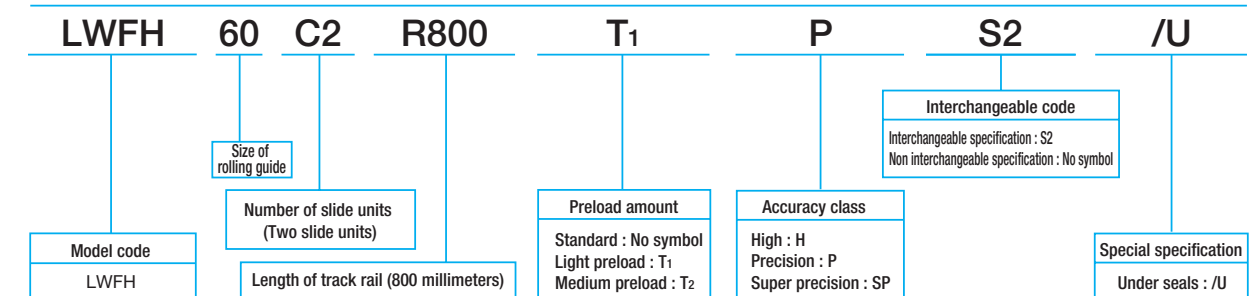



**Flange type mounted from top/bottom**  
**LWFF**

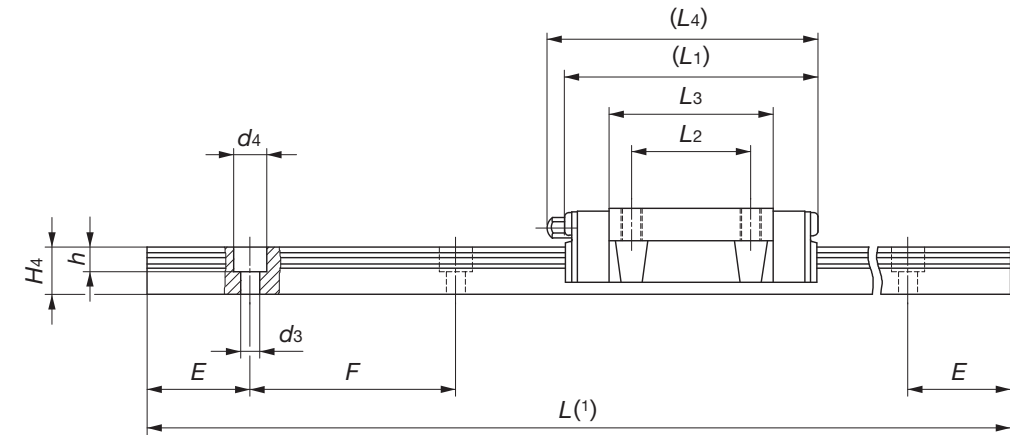
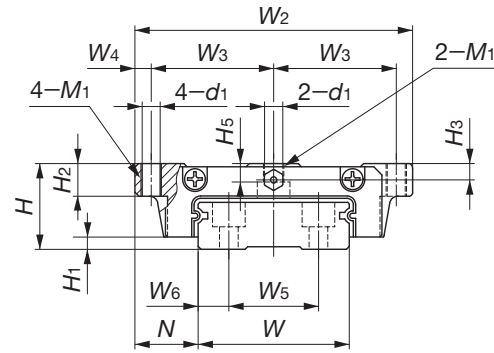

Model number	Interchangeable	Mass (Ref.)		Dimensions of assembly mm			Dimensions of slide unit mm									
		Slide unit kg	Track rail kg/m	H	H <sub>1</sub>	N	W <sub>2</sub>	W <sub>3</sub>	W <sub>4</sub>	L <sub>1</sub>	L <sub>2</sub>	L <sub>3</sub>	L <sub>4</sub>	d <sub>1</sub>	M <sub>1</sub>	H <sub>2</sub>
LWFF 33	☆	0.14	2.41	17	2.5	13.5	60	26.5	3.5	53.5	26	35.3	56	3.3	M4	6
LWFF 37	☆	0.23	3.05	21	3	15.5	68	30	4	62	29	40	66	4.4	M5	8
LWFF 42	☆	0.49	4.30	27	3	19	80	35	5	75	40	52.2	86	5.3	M6	10
LWFF 69	☆	1.40	9.51	35	4	25.5	120	53.5	6.5	109	60	79.5	119	7	M8	14

H <sub>3</sub>	H <sub>5</sub>	Dimensions of track rail mm										Mounting bolt for track rail mm Bolt size x length	Basic dynamic load rating <sup>(2)</sup> C N	Basic static load rating <sup>(2)</sup> C <sub>0</sub> N	Static moment rating <sup>(2)</sup>		
		W	H <sub>4</sub>	W <sub>5</sub>	W <sub>6</sub>	d <sub>3</sub>	d <sub>4</sub>	h	E	F	T <sub>0</sub> N·m				T <sub>x</sub> N·m	T <sub>y</sub> N·m	
3.2	3.7	33	10	18	7.5	4.6	8	6	20	40	M4×10	6 530	8 610	146	49.0 289	49.0 289	
4	4.5	37	11.5	22	7.5	4.6	8	6	25	50	M4×12	9 840	12 200	235	80.0 480	80.0 480	
6	7	42	14	24	9	4.6	8	6	30	60	M4×16	15 500	19 400	424	165 904	165 904	
8	8	69	19.5	40	14.5	7	11	9	40	80	M6×22	34 900	44 100	1 560	581 2 940	488 2 460	

Note<sup>(1)</sup> : Track rail lengths are shown in Table 11.1 on page B-122.

<sup>(2)</sup> : The directions of basic dynamic load rating (C), basic static load rating (C<sub>0</sub>) and static moment rating (T<sub>0</sub>, T<sub>x</sub>, T<sub>y</sub>) are shown in the sketches below. The upper values in the T<sub>x</sub> and T<sub>y</sub> columns apply to one slide unit, and the lower values apply to two slide units in close contact.

Remark 1 : The mark ☆ indicates that interchangeable specification products are available.  
2 : The appended track rail mounting bolts are hexagon socket head bolts of JIS B 1176 or equivalent.  
3 : For grease nipple specifications, see page 99.

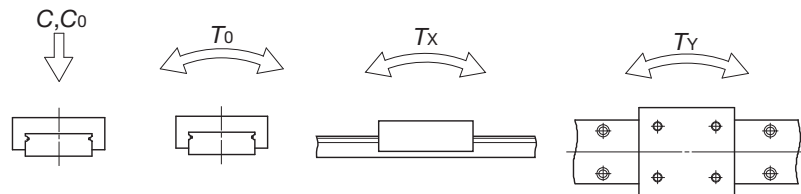

Example of identification number of assembled set (For details, see "Identification number and specification".)

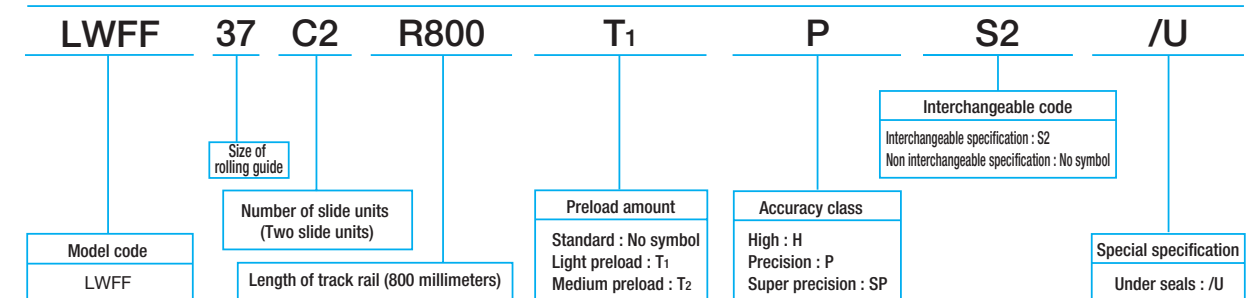

B

LWFF, LWFF, LWFF

Block type mounted from top  
**LWFS**  
**LWFS...SL** (Stainless steel made)

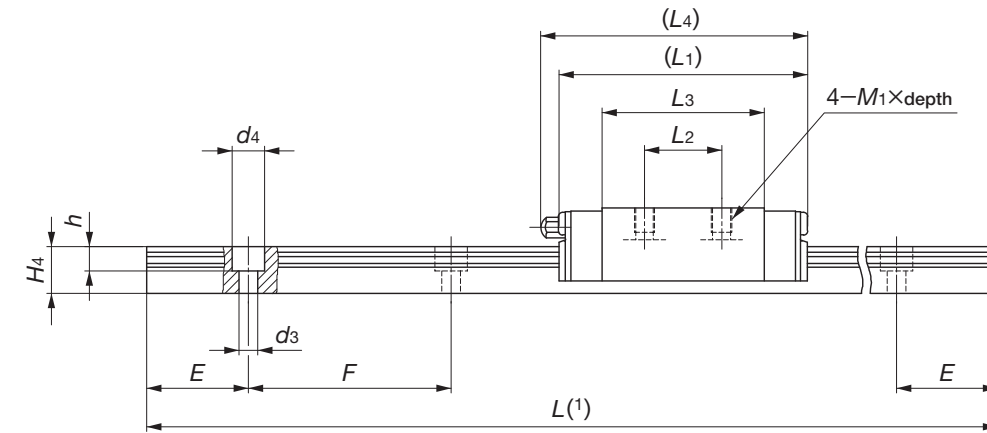
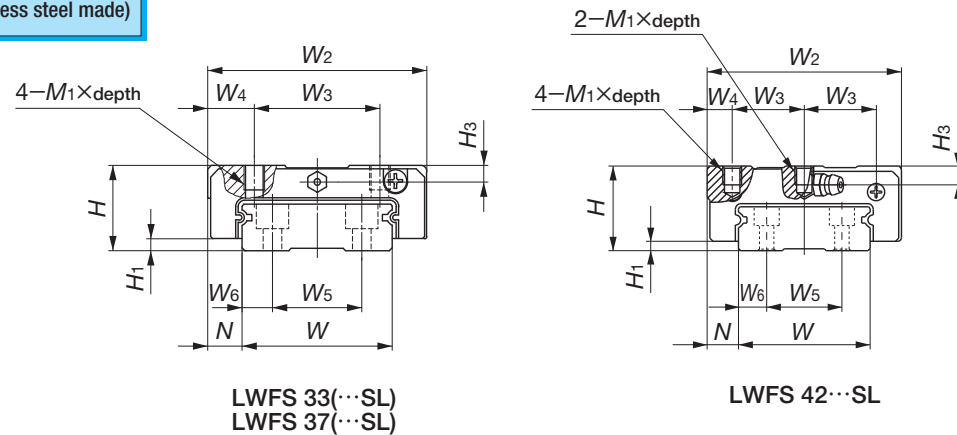

Model number	Interchangeable	Mass (Ref.)		Dimensions of assembly mm			Dimensions of slide unit mm							
		Slide unit kg	Track rail kg/m	H	H <sub>1</sub>	N	W <sub>2</sub>	W <sub>3</sub>	W <sub>4</sub>	L <sub>1</sub>	L <sub>2</sub>	L <sub>3</sub>	L <sub>4</sub>	M <sub>1</sub> ×depth
LWFS 33	☆	0.13	2.41	17	2.5	8.5	50	29	10.5	53.5	15	35.3	56	M4×5
LWFS 33...SL	☆													
LWFS 37	☆	0.20	3.05	21	3	8.5	54	31	11.5	62	19	40	66	M5×6
LWFS 37...SL	☆													
LWFS 42...SL	☆	0.40	4.30	27	3	10	62	23	8	75	32	52.2	86	M6×6

H <sub>3</sub>	Dimensions of track rail mm										Mounting bolt for track rail mm Bolt size x length	Basic dynamic load rating <sup>(2)</sup> C N	Basic static load rating <sup>(2)</sup> C <sub>0</sub> N	Static moment rating <sup>(2)</sup>		
	W	H <sub>4</sub>	W <sub>5</sub>	W <sub>6</sub>	d <sub>3</sub>	d <sub>4</sub>	h	E	F	T <sub>0</sub> N·m				T <sub>x</sub> N·m	T <sub>y</sub> N·m	
3.2	33	10	18	7.5	4.6	8	6	20	40	M4×10	6 530	8 610	146	49.0 289	49.0 289	
4	37	11.5	22	7.5	4.6	8	6	25	50	M4×12	9 840	12 200	235	80.0 480	80.0 480	
6	42	14	24	9	4.6	8	6	30	60	M4×16	15 500	19 400	424	165 904	165 904	

Note<sup>(1)</sup> : Track rail lengths are shown in Table 11.1 on page B-122 and Table 11.2 on page B-123.  
<sup>(2)</sup> : The directions of basic dynamic load rating (C), basic static load rating (C<sub>0</sub>) and static moment rating (T<sub>0</sub>, T<sub>x</sub>, T<sub>y</sub>) are shown in the sketches below. The upper values in the T<sub>x</sub> and T<sub>y</sub> columns apply to one slide unit, and the lower values apply to two slide units in close contact.  
 Remark 1 : The mark ☆ indicates that interchangeable specification products are available.  
 2 : The appended track rail mounting bolts are hexagon socket head bolts of JIS B 1176 or equivalent.  
 For stainless steel type Linear Way F, stainless steel bolts are appended.  
 3 : For grease nipple specifications, see page 99.

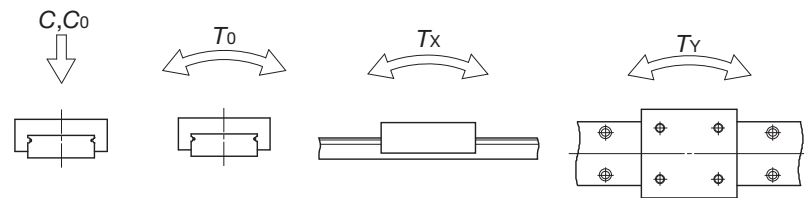

Example of identification number of assembled set (For details, see "Identification number and specification".)

